

STAN RELJIC (BROKER)
CENTURY21 MILLENIUM INC. BROKERAGE

AVAILABLE



THE GROVE INTERIOR BUNGALOW

PRICE	\$540,900
SQUARE FOOTAGE	1213 SQ FT
PROPERTY FEATURES	
→ 2 BEDROOMS	→ WALK-IN PANTRY
→ 2 FULL BATHROOMS	→ SINGLE-CAR GARAGE

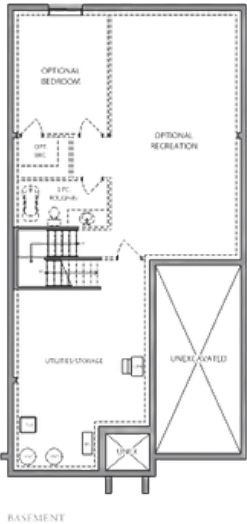
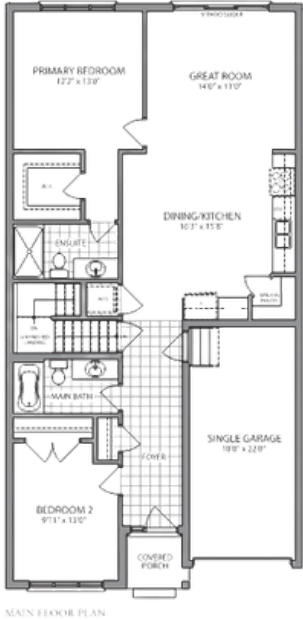

BASMENT

MAIN FLOOR PLAN



stan@live4seasons.ca



705-888-5124

WWW.REIDSHERITAGEHOMES.COM

All drawings are Artist's Concepts only and may vary slightly from the final product. E&O.E. The home shown may be the reverse of the home purchased. Actual useable floor space may vary from stated area, and square footage has been calculated based on useable living space according to TARION rules and does not include garage or basement areas (unless otherwise stated). More detailed information is set out in the Agreement of Purchase and Sale. Drawings may show optional features which may not be included in the base Purchase Price. Bulkheads and box outs may be required as chases for plumbing and mechanical. Garage man door, if applicable, location may vary subject to grade. In an ongoing review of our homeowner's needs, changes may have been incorporated into our "New Home Features" and construction techniques. All plans and specifications are subject to reasonable modification, as necessary, at the discretion of the Vendor, without notice. © 03/2026

